

**OPERATION AND MAINTENANCE**



## **Three Movement Time Lock**

### **1600 Series**

Manufactured in SWITZERLAND by RELHDIS SA

Rte de Neuchâtel 15a

CH 2072 Saint-Blaise

Telephone +41 32 756 10 40

FAX +41 32 756 1049

email: mail @ relhdis.com

# OPERATION

## Set the time Lock

1. Determine the number of hours the 64 Series must remain locked.
2. Insert the winding key through the eyelet opposite each movement.
3. Turn the key in a counterclockwise direction until the desired number of locking hours is directly under the pointer. Repeat for the second and third movements.
4. Once all the movements are wound, verify that the movements are running.

**Important: Never lock the door unless at least two movements are running.**

5. Activate the snubber block by pressing down the locking lever to the lock position.

**Day Open Feature:** Once the movements are wound, the time lock can be left in the open position, permitting the safe or vault to remain unlocked during business hours. To relock the safe or vault, activate the snubber block by pressing down the locking lever to the lock position.

**Release Feature:** The time lock can be manually changed from the lock to the open position. To unlock the safe or vault, activate the snubber block by moving the manual release pint to the right. The door can then be opened without unwinding or releasing time on the movements.

# MAINTENANCE

Relhdis recommends that the following procedures be performed annually.

**Important: only a trained technician or local watch maker should perform the movement maintenance (cleaning and calibrating).**

## Tools Required

Large slotted screwdriver  
Non-linting shop cloth  
Miniature slotted screwdriver  
Small phillips screwdriver  
5/32" (4mm) allen wrench  
Soft-bristle brush

## Remove the mounting plate and replace the movements

1. Remove the four screws securing the cover to the case using a small phillips screwdriver. Lift off the cover.
2. Remove the two brass slotted screws located on either side of the carrier, using a large slotted screwdriver. Remove the carrier and locking lever.
3. Remove the two socket screws located on either side of the lever mount, using a 5/32" (4mm) allen wrench. Lift the mounting plate off the time lock case.
4. Remove the three slotted screws, securing each movement to the mounting plate using a miniature slotted screwdriver.
5. Remove each movement, handling them by the winding stem only.
6. Replace the old movements with new movements (temporary or permanent). Secure each movement with three slotted screws.

## Clean the Time-Lock

1. From the time-lock case, remove the two brass slotted screws that secure the snubber block in its tract, using a large slotted screwdriver.
2. Remove the snubber block.
3. Remove dust from the interior of the case and the snubber block using a hand bellows or soft-bristle brush. Inspect all components for signs of damage or excessive wear.

**Note: Lubrication is NOT recommended**

## Reassemble the Time Lock

1. Replace the snubber block and the two brass slotted screws.
2. Reattach the mounting plate to the time lock casing using the two socket screws.
3. Replace the lever, ensuring that it is under the snubber block shaft.
4. Replace the carrier with caution while applying pressure to the spring against the case wall. Ensure that the pins on the dial faces are clear of the carrier. Install the two brass slotted screws to secure the carrier.
5. Adjust the coordination of the movements with the release mechanism, so that they are synchronized. To modify the pressure required to release the carrier, adjust the cam post (the pin through the lever) from the bottom of the case, using a miniature slotted screwdriver.
6. Clean any areas handled when reattaching the mounting plate to the case.
7. Dust and clean the cover on both side. Replace the cover using the four screws.

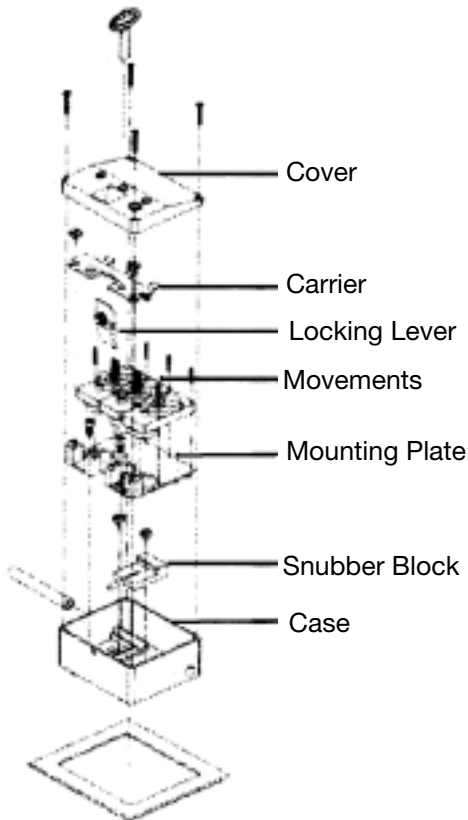

## Notes on the Relor Movement.

**Movements with an accelerator (snap action) do not require calibration.** They unlock as follows:

Once the "0 hour" position is reached, a separate gearing system accelerates the rotation of the dial. The carrier is engaged, releasing the bolt blocking arm.

**Movements without the accelerator feature may be calibrated as follows:** Set the time on the movements so that only one movement at a time will release the bolt blocking arm. To this, wind more time on the movement that is not being calibrated. When the movement that is being calibrated releases the blocking arm, loosen the retaining screw in the center of the movement dial and rotate it so that it aligns with "0". Repeat this procedure for the second movement if necessary.

**Standard Movements:** (Those without a reset option): If mistakenly set for a period of time longer than desired, cannot be reset by rotating the key clockwise. Doing so may result in damage to the movement.

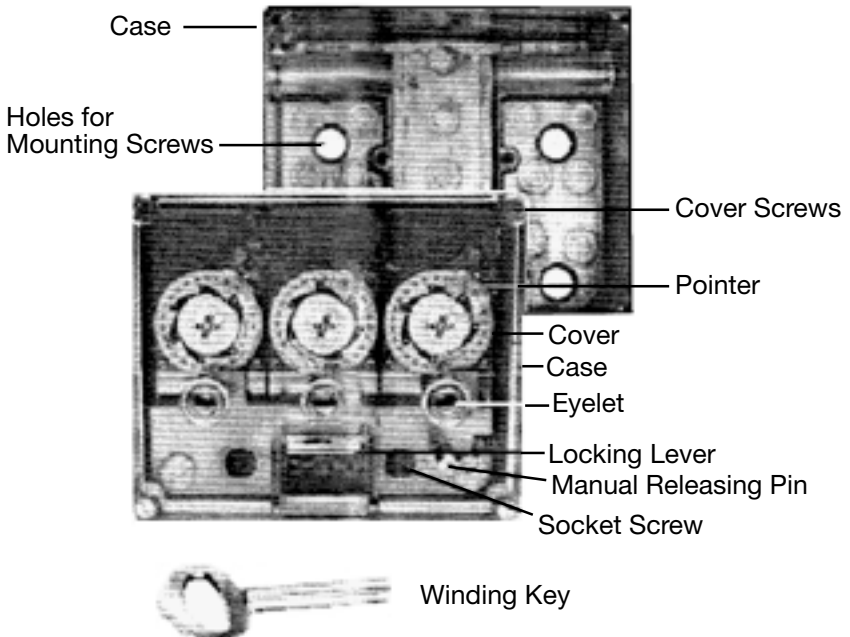

## **Timelock Warranty and Guarantee**

We are proud to offer the finest warranty/guarantee in the industry.

1. The guarantee program provides to the OEM a reimbursement to be applied against any opening/repair cost incurred when it has been determined that the mechanical timelock is the reason for the failure. This excludes errors in the installation, service or operation of the mechanical timelock. Such reimbursements are subject to the following conditions:
  - a. Any work performed on the container must be accomplished by a "qualified" timelock technician. A "qualified" timelock technician is a recognized locksmith professional who has been trained in the area of mechanical timelocks in a recognized facility and can provide reasonable proof thereof.
  - b. The final determination of the cause of the lockout will be with the manufacturer based on a written report submitted by the qualified timelock technician and an examination of the returned mechanical timelock.
  - c. Upon valid verification of the mechanical timelock's failure, Relhdis will reimburse a mutually agreed upon "not to exceed" sum to the safe or vault manufacture – not the safe technician or the end user. This sum shall be within the limits of the current "reasonable" pricing structure of the safe and vault industry for similar openings and repairs.
  - d. This conditional guarantee covers only the operation of the mechanical timelock and reimburses only the charges described in "c" above. This guarantee is intended to be effective only in the event that the Relhdis mechanical timelock fails in the field and requires a "forced" opening.
2. The twenty-four (24) month warranty against factory defects in manufacturing covers the replacement of the Relhdis mechanical timelock. It is a direct one-to-one replacement in which the defective mechanical timelock is exchanged for a new mechanical timelock with Relhdis paying the freight both ways.
  - a. This warranty does not cover any misuse in the installation, day-to-day operation, or servicing of the mechanical timelock.
  - b. Relhdis mechanical timelocks are to be free of defects in material and workmanship for a period of two years (24 months). This two-year period begins with the shipment from seller's point of manufacture.
  - c. This program is subject to revision without notice. Please contact your Relhdis Lock Sales representative for the current status.



**Vault Structures, Inc.**  
3640 Work Drive  
Fort Myers, FL 33916  
Telephone 239•332•3270  
800•226•3990  
[www.vaultstructures.com](http://www.vaultstructures.com)

Manufacturer reserves the right to change product specifications without notice.