

Vault Structures Inc. — Vision Series Panels

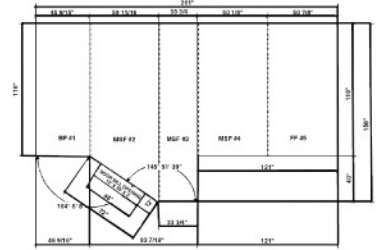

*Vaulting
Security
Solutions
to a New Level*

Tel: 800 226 3990



**Vision Series
Lightweight**

Class M – 3 1/2" Thick	19 lbs.
Class I – 5 1/2" Thick	25 lbs.
Class II – 10 1/2" Thick	44 lbs.
Class III – 12" Thick	75 lbs.

All the strength and security you have come to expect from VSI, in a new lightweight format.

When space and weight are a major concern ...

VSI has the *Vision* to maximize your vault security.

Be a Part of VSI's  **vision**

The lightweight modular vault weighs less than half of a modular concrete vault, allowing the vault to be placed anywhere,

Carries the same Underwriters Laboratory rating as concrete panels. The pressurized laminate is enclosed in corrosion resistant galvanized steel.

The panels are sized to meet the specific job requirement. The vault ceiling panels span up to 16' and may be installed either across the width or depth of the vault. For spans that exceed 14', an I-Beam is required.

Coordinated with your architects, designers and engineers throughout the fabrication process. Delivery and installation by our experienced teams to provide a total solution.

VSI Class "M" Modular Vault Panel System meets U. S. Government's DEA (Drug-Enforcement Administration) standards and has been used on numerous GSA (General Services Administration) projects. All materials and workmanship are guaranteed to be of the highest quality and are listed by Underwriters Laboratory.



Made in America

Manufacturer reserves the right to change product specifications without notice.

Safety, Strength & Dependability

VSI's Vision series panels are ideal for vaults on a second story or for vaults with a basement

Why choose Vision? Simple — Vision series panels offers all the dependability you have come to know from Vault Structures' modular vault panels in a lighter, thinner model.

Maximize your space and still feel secure with our UL listed lightweight panels. Less weight equals fewer restrictions so you can put the vault wherever you want it.

TOP FEATURES

- U. L. Rated : Class M, Class I, Class II, Class III
- Panels are thinner than the Aegvs Series panels.
- Panels weigh less than Aegvs Series panels.
- Panels are made with a solid pressurized laminate core.

Made in America

U.L. CLASS	Herc^{VSI}lite HERCVLITE SERIES UHPC	vision VISION SERIES ORGANIC TRADITIONAL	aeg^{VSI}s AEGVS SERIES CONCRETE TRADITIONAL
M	2" 28#/SQ.FT.	3 1/2" 19#/SQ.FT.	4" 53#/SQ.FT.
1	2 1/2" 35#/SQ.FT.	5 1/2" 25#/SQ.FT.	5" 69#/SQ.FT.
2	4" 55#/SQ.FT.	10 1/2 " 44#/SQ.FT.	7" 95#/SQ.FT.
3	7" 96#/SQ.FT.	12 " 75#/SQ.FT.	12" 169#/SQ.FT.

* The standard limit is set at 14' for all classes due to access and installation considerations



Vault Structures, Inc
3640 Work Drive
Fort Myers, FL 33916
800 226 3990
sales@vaultstructures.com