



VISION SERIES PANELS

All the strength and security you have come to expect from VSI, in a new lightweight format.

Vision Series Lightweight

Class M - 3 1/2" Thick 19lbs. per sq. ft.
*Std. Panel Width 30"

Class I - 5 1/2" Thick 25lbs. per sq. ft.
*Std. Panel Width 29"

Class II - 10 1/2" Thick 44lbs. per sq. ft.
*Std. Panel Width 24"

Class III - 12" Thick 75lbs. per sq. ft.
*Std. Panel Width 24"

When space and weight are a major concern...

VSI has the Vision to maximize your vault security.

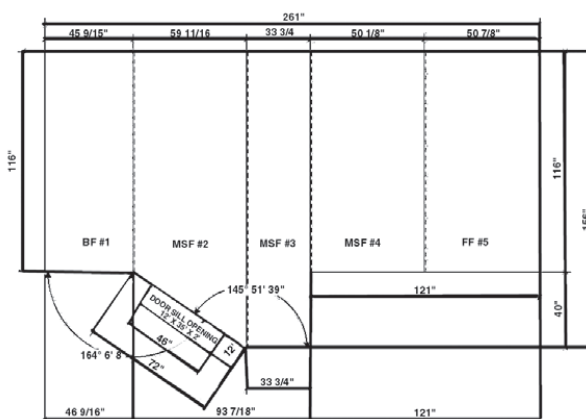

*Smaller panel widths available at additional cost, consult sales for details.

VSI - BE A PART OF OUR VISION

The lightweight modular vault weighs less than half of a modular concrete vault, allowing the vault to be placed anywhere, and carries the same Underwriters Laboratory rating as concrete panels. The pressurized laminate is enclosed in corrosion resistant galvanized steel.

The panels are sized to meet the specific job requirement. The vault ceiling panels span up to 16' and may be installed either across the width or depth of the vault. For spans exceeding 14", an I-Beam is required.

Coordinated with your architects, designers and engineers throughout the fabrication process. Delivery and installation by our experienced teams to provide a total solution.

VSI Class "M" Modular Vault Panel System meets U.S. Government's DEA (Drug Enforcement Administration) standards and has been used on numerous GSA (General Services Administration) projects. All materials and workmanship are guaranteed to be of the highest quality and are listed by Underwriters Laboratory.



Manufacturer reserves the right to change product specifications without notice.



VISION SERIES PANELS

Safety, Strength & Dependability

VSI's Vision series panels are ideal for vaults on a second story or for vaults with a basement

VSI - WHY CHOOSE VISION?

Simple – VSI's Vision series panels offers all the dependability you have to come to know from Vault Structures' modular vault panels in a lighter, thinner model.

Maximize your space and still feel secure with our UL listed lightweight panels. Less weight equals fewer restrictions so you can put the vault wherever you want it.

TOP FEATURES

- U.L. Rated: Class M, Class I, Class II, and Class III
- Panels are thinner than the Aegvs Series panels.
- Panels weigh less than Aegvs Series panels.
- Panels are made with a solid pressurized laminate core.

U.L. CLASS	HERCVLITE SERIES UHPC		VISION SERIES ORGANIC TRADITIONAL		AEGVS SERIES CONCRETE TRADITIONAL	
	Thickness / lbs. per sq. ft.		Thickness / lbs. per sq. ft.		Thickness / lbs. per sq. ft.	
M	2"	28 lbs.	3 1/2"	19 lbs.	3"	40 lbs.
1	2-1/4"	32 lbs.	5 1/2"	25 lbs.	4"	55 lbs.
2	3-1/2"	49 lbs.	10 1/2"	44 lbs.	6"	82 lbs.
3	6-1/2"	91 lbs.	12"	75 lbs.	9"	125 lbs.

Note: The standard panel length limit is set at 14' for all classes due to access and installation considerations.



Manufacturer reserves the right to change product specifications without notice.